

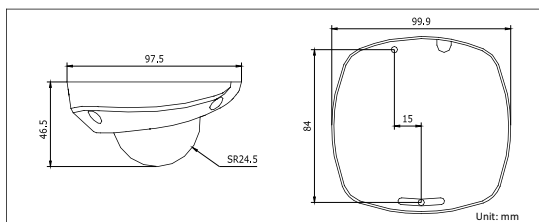

#### Key Features

- 1/3" progressive scan CMOS image sensor
- Up to 2 Megapixel resolution (1600 x 1200)
- 6 Simultaneous users
- H.264/MPEG4/MJPEG streaming
- HD 720P Real time video
- Day/night auto switch
- Vandal proof housing
- IP66 rating
- PoE
- Compatible with Videoswitch Net Recorders

#### Dimensions



#### Order Codes

<b>Vi-C5111</b>	<b>2Mpixel IP Mini Dome Camera</b>
Vi-C5111/2.8	2.8mm lens (optional)
Vi-C5111/4	4mm lens
Vi-C5111/6	6mm lens (optional)
Vi-C5111/8	8mm lens (optional)

#### Specification

##### Camera

Image sensor	1/3" progressive scan CMOS
Minimum Illumination	0.1 lux @F1.2, AGC ON, sense x5 0.5 lux @F1.2, AGC ON
Shutter	1/25s to 1/100,000s
Lens	4mm @F1.8 (2.8, 6, 8mm optional), angle of view: 68°
Lens mount	Ø12
Angle Adjustment	Pan: ± 15°, tilt: 0 ~ 90°, rotation: ± 15°
Recommended orientation	Horizontal, vertical with limited pan adjustment
Day & Night	Electronic

##### Compression

Video compression	H.264 / MPEG4 / MJPEG
Bit rate	32 Kbps ~ 16 Mbps
Dual stream	Yes (different video compression)
Simultaneous users	6

##### Image

Max image resolution	1600x 1200
Frame rate	12.5fps (1600 x 1200) 25fps (1280 x 960) 25fps (1280 x 720)
Image settings	Saturation, brightness, contrast adjustable by client software or web browser

##### Network

Network storage	NAS
Alarm trigger	Motion detection
Protocols	TCP/IP, HTTP, DHCP, DNS, DDNS, RTP, RTSP, PPPoE, SMTP, NTP, SNMP, HTTPS, FTP, 802.1x, Qos (SIP, SRTP, IPv6 optional)
Security	User Authentication, Watermark
Compatibility	Videoswitch, ONVIF, PSIA, CGI

##### Interface

Communications interface	1 RJ45 10M / 100M ethernet port
Reset button	Yes

##### Physical & Environmental

Operating temperature	-10°C ~ 60°C
Humidity	90% or less (non-condensing)
Power supply	12 VDC ± 10%, PoE (802.3af)
Power consumption	4W
Impact protection	IEC60068-275Eh, 50J; EN50102, up to IK10
Weatherproofing	IP66
Dimensions	99.9 × 97.5 × 46.5 mm
Weight	0.25kg

